

3960 CYLINDER INSTRUCTIONS

Tailpiece and Assembly Drawings

Tailpiece 1:
Component No: 2-639-7000

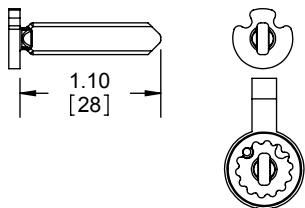

Used on:
3453 Lever (Entry)
3450 Lever (Office)
3480 Lever (Storeroom)

Tailpiece 6:
Component No: 2-639-7005

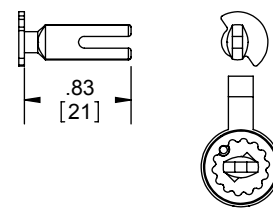

Used on:
3114 Deadbolt (Exterior Cylinder)
3214 Deadbolt (Exterior Cylinder)

Tailpiece 2:
Component No: 2-639-7001

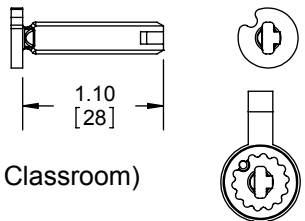

Used on:
3470 Lever (Classroom)
3495 **Outside** Lever (Intruder Classroom)

Tailpiece 7:
Component No: 2-639-7006

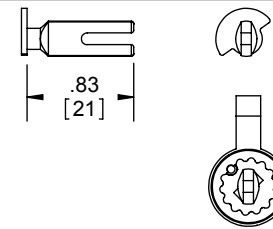

Used on:
3114 Deadbolt (Interior Cylinder)
3214 Deadbolt (Interior Cylinder)

Tailpiece 3:
Component No: 2-639-7002

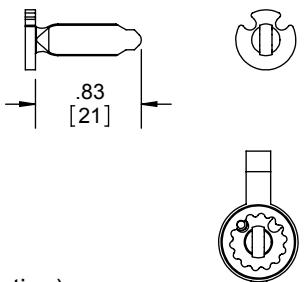

Used on:
2550 Lever (Office)
2553 Lever (Entry)
2580 Lever (Storeroom)
3553 Lever (Entry)
3550 Lever (Office)
3579 Lever (Keyed Communicating)
3580 Lever (Storeroom)
3753 Lever (Entry)

Tailpiece 8:
Component No: 2-639-7007

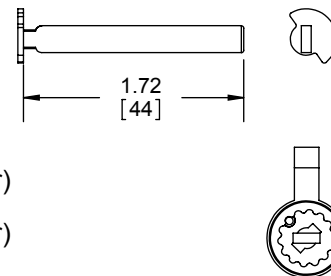

Used on:
3115 Deadbolt (Single Cylinder)
3118 Deadbolt (Classroom)
3215 Deadbolt (Single Cylinder)

Used on:
3453 Knob (Entry)
3553 Knob (Entry)
3480 Knob (Storeroom)
3580 Knob (Storeroom)

Tailpiece 9:
Component No: 2-639-7008

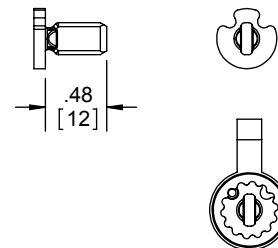

Used on:
3653 Lever (Entry)
3670 Lever (Classroom)
3680 Lever (Storeroom)

Tailpiece 4:
Component No: 2-639-7003

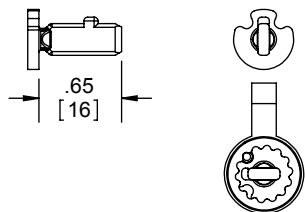

Used on:
3470 Knob (Classroom)
3570 Knob (Classroom)

Tailpiece Z:
Component No: 2-639-7087

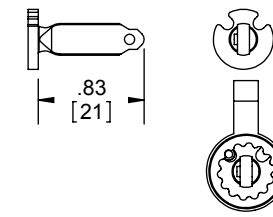

Used on:
2570 Lever (Classroom)
3473 Lever (Corridor)
3570 Lever (Classroom)
3573 Lever (Corridor)

ORDERING INFORMATION:

KEYWAY: _____

KEYING: _____

5-PIN OR 6-PIN: _____

(TAILPIECES SUPPLIED WITH CYLINDER)

IF ORDERING STANDARD SCHLAGE "C" KEYWAY LOCKSET (ANSWER THESE ADDITIONAL QUESTIONS):

LOCKSET SERIES (EX: 3100 SERIES): _____

FUNCTION (EX: 53 FUNCTION): _____

HANDLE (LEVER OR KNOB): _____

TAILPIECE *(From Chart Above)*: _____

Tailpiece X:
Component No: 2-639-7094

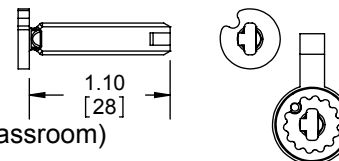

Used on:
3495 **Inside** Lever (Intruder Classroom)

3960 - Cylinder Kit (2 Keys, 1 Cylinder)

Finishes: US4 or US26D
C Keyway - Standard
Brass 6-pin Capable

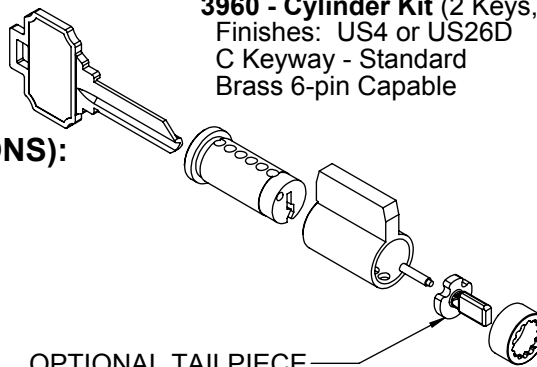

OPTIONAL TAILPIECE

